



Gotische Stube

Location

- 1st Floor
- Westen tract, north side
- Not wheelchair accessible (3 steps)

Size

- Length in m 7
- Width in m 5
- m² 35

Capacity

- U-shape (with chairs around outside) 15 persons
- Classroom 15 persons
- Theatre seating 30 persons

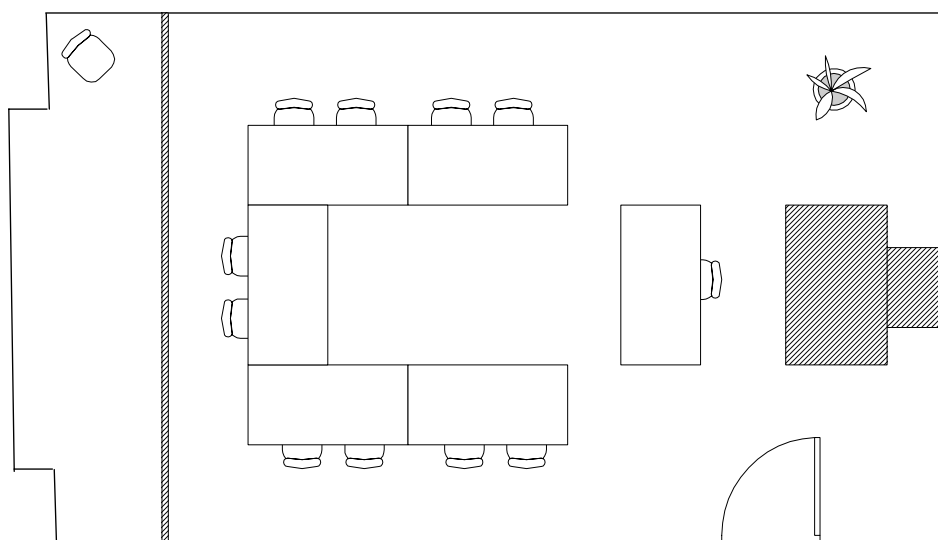

A gothic room?

In the 19th century this room was modernised by Robert Lucas Pearsall de Willsbridge and received its present neo-gothic character. He refitted the walls with customised decorative wooden panels. The original ceiling from 1452 Pearsall left uncovered but it was later repainted.