



Pearsall Zimmer

Location

- 2nd Floor
- Westen tract, north side
- Not wheelchair accessible (3 steps)

Size

- Length in m 8
- Width in m 5
- m² 40

Capacity

- U-shape (with chairs around outside) 18 persons
- Classroom 20 persons
- Theatre seating 40 persons

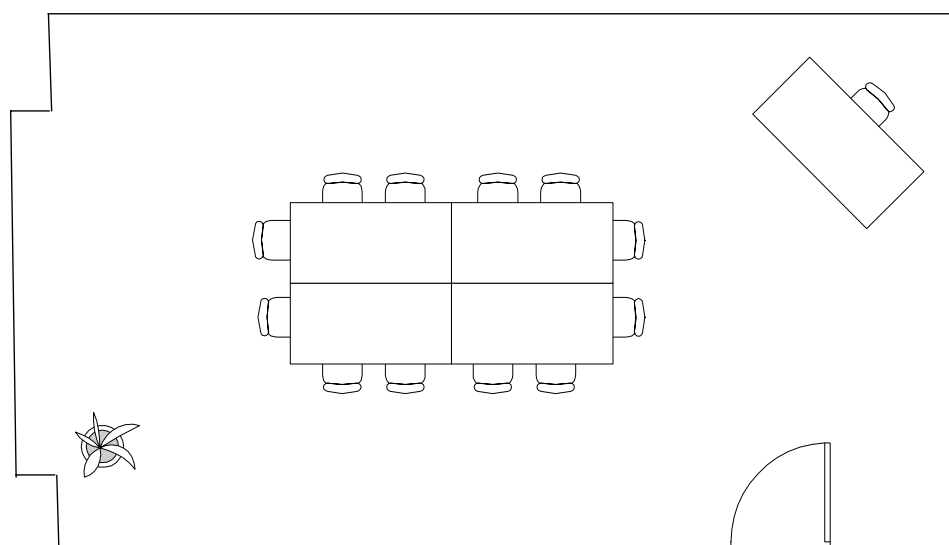

Where does the name come from?

The almost forgotten composer Baron Robert Lucas Pearsall de Willsbridge remodelled the middle-age fortress in 1850 to its present neo-gothic castle form. He bought Schloss Wartensee in 1843 and worked on commissions from St Gallen patrons.